

MBB C 750 L

**ROBUST AND
LEIGHTWEIGHT**

LIFETIME EXCELLENCE



MBB C 750 L

ROBUST AND LEIGHTWEIGHT

MBB C 750 L

- The lightweight tail lift for small vans up to 6,5 t
- Lifting capacity 750 kg with 600 mm load distance
- Torsion-resistant two-cylinder lifting mechanism
- Even, parallel movement to loading floor
- Single-piece underride guard as standard
- Simple attachment thanks to bolttable mounting plates

LOAD DIAGRAM

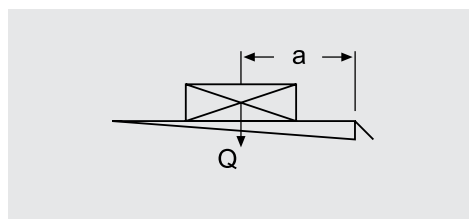

MBB C 750 L	
a (mm)	Q (kg)
600	750
700	650
820	550
1120	400

WEIGHTS

Plattformtyp	width(mm)	depth (mm)	weight (kg)
Aluminium	2100	1450	from 199 kg

TECHNICAL DATA

Lifting capacity	750 kg
Main beam	120 x 120 mm
Lifting gear hydraulics	1 x lifting cylinder / 1 x tilting cylinder
Platform overlap with floor	-57
Lifting arm pitch	620 mm
Load centre, longitudinal	600 mm
Load centre, across centre	Central, 50% of rated load on one side
Inclination angle of the platform	+90° bis -10°

DIMENSIONS

Lifting arm lengths (mm)	600
H (max.) loading height, unloaded	1080
H (min.) loading height, loaded	680
F (max.) middle of main beam to upper edge of loading floor	580
K (min.) at dimension F (max.)	443
D (min.) installation dimension, minimum	565
F (min.)	420
K (max.) at dimension F (min.)	578
D (max.) installation dimension, maximum	700
G (max.) unloaded (middle of main beam to ground)	500
G (min.) loaded	260

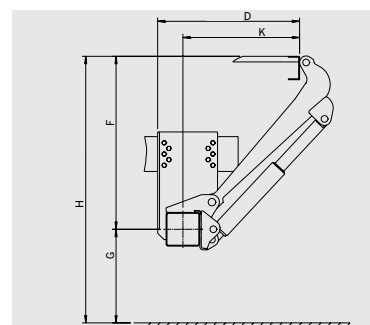

AVAILABLE FOR

- Mercedes-Benz Springer 3 / 5
- Volkswagen Crafter 30 / 35 / 50
- Iveco Daily
- Citroen Jumper (Relay) / Fiat Ducato / Peugeot Boxer
- Ford Transit
- Renault Master
- Further vehicle types on request

PALFINGER TAIL LIFTS GmbH
 Fockestraße 53
 27777 Ganderkesee
 Germany
www.palfinger.com

